

DRAW A PICTURE

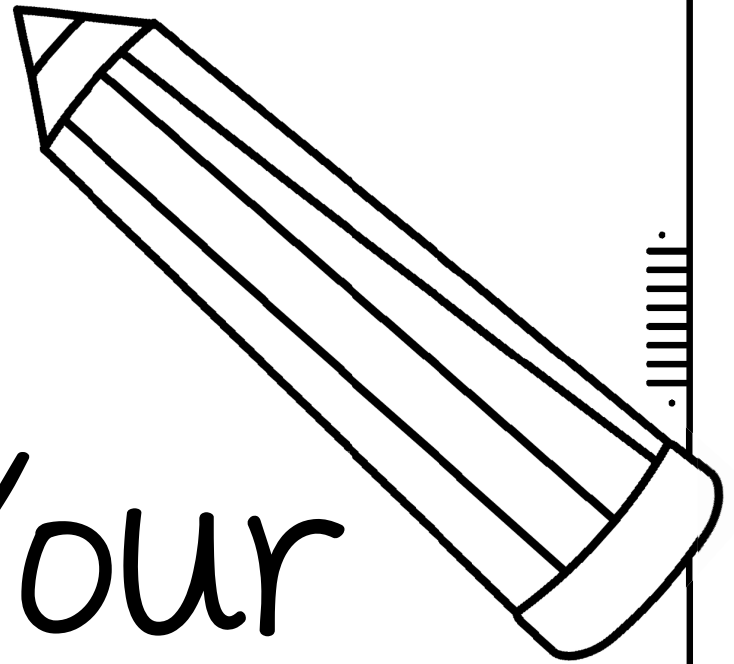

of Your
House

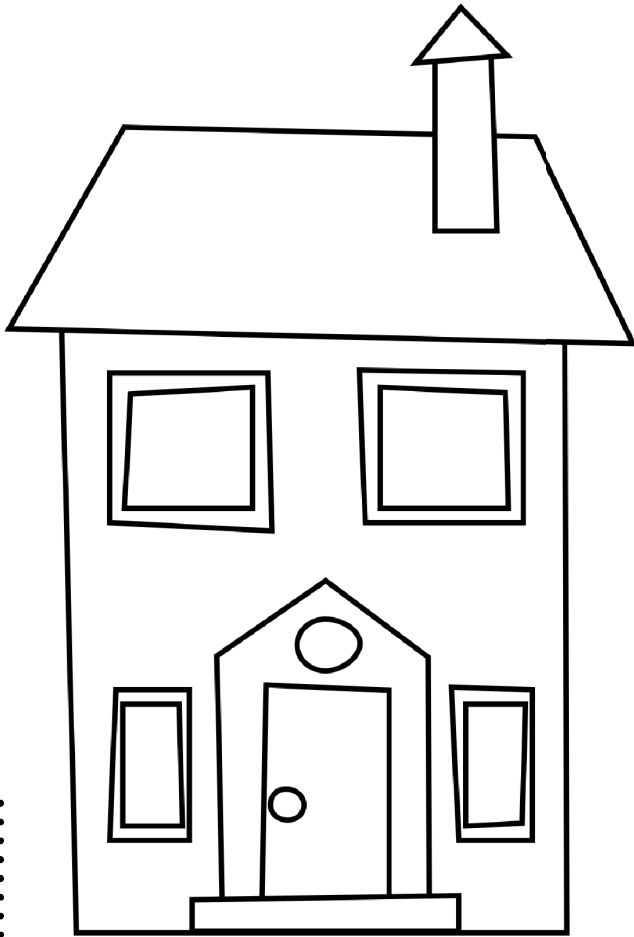
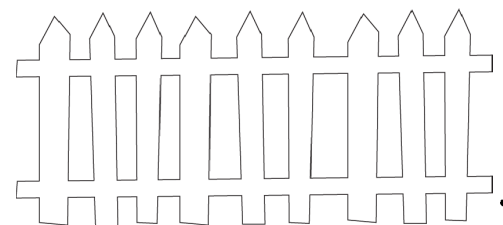

Graphics by:

From the Pond <https://www.teacherspayteachers.com/Store/From-The-Pond>

Poppydreamz Digital Art <http://www.teacherspayteachers.com/Store/Poppydreamzdigitalart>

Copyright ©2016 Tools to Grow®, Inc. All rights reserved.

www.ToolsToGrowOT.com

DRAW A PICTURE

of Your House

Use the space below to draw a picture of the place that you live. Try to do your best to include as many details as possible. This may include windows, door color, shrubs, flowers, chimney, etc. Next, fill in the blanks below to write your name and full address.

Name:

Street:

City:

Zip Code:

DRAW A PICTURE

of Your House

Use the space below to draw a picture of the place that you live. Try to do your best to include as many details as possible. This may include windows, door color, shrubs, flowers, chimney, etc. Next, fill in the blanks below to write your name and full address.

Name: _____

Street: _____

City: _____

Zip Code: _____

DRAW A PICTURE

of Your House

Use the space below to draw a picture of the place that you live. Try to do your best to include as many details as possible. This may include windows, door color, shrubs, flowers, chimney, etc. Next, fill in the blanks below to write your name and full address.

Name: _____

Street: _____

City: _____

Postal Code: _____

DRAW A PICTURE

of Your House

Use the space below to draw a picture of the place that you live. Try to do your best to include as many details as possible. This may include windows, door color, shrubs, flowers, chimney, etc. Next, fill in the blanks below to write your name and full address.

Name: _____

Street: _____

City: _____

Postal Code: _____